

MM - ST M8 ...			
Item	Description	L1 [mm]	L2 [mm]
418777	MM - ST M8x40	40	30
418778	MM - ST M8x60	60	50
418779	MM - ST M8x80	80	70
418780	MM - ST M8x100	100	90

MM - ST M10 ...			
Item	Description	L1 [mm]	L2 [mm]
418782	MM - ST M10x40	40	30
418791	MM - ST M10x60	60	50
418792	MM - ST M10x80	80	70
418793	MM - ST M10x100	100	90

L1 = total length of threaded bolt / L2 = max. height above channel surface

L1 + L2 have tolerances of  $\pm 1$  mm

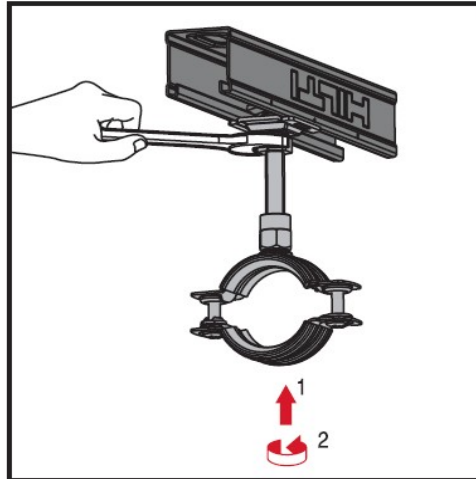
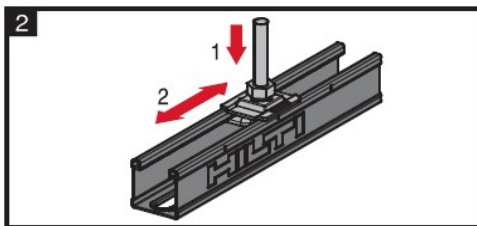
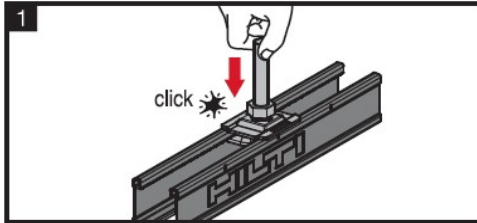

Immediate height adjustment	Further height adjustment
<p>During mounting the MM-ST to the channel --&gt; limited height adjustment</p>	<p>After mounting the pipe ring to MM-ST --&gt; further height adjustment possible (depending on the height of the MM - channel)</p>
<p>1. Push MM-ST into channel</p> <p>2. Move to right position</p>	<p>1. Mount pipe ring to threaded stud</p> <p>2. Hold up nut with a wrench</p> <p>3. Overwind the stamp on the threaded stud through turning the pipe ring to correct height</p> <p>4. Final fixing of nut</p>