

	Nuron SID 4-22	
	Nuron SID 6-22	
	Nuron SIW 4-22	
	CPC SID A 22-A/18-A	
	CPC SIW 6AT-A22	
		18 ft-lb

KH 1/4"	h_i^*	$h_{nom1} = 1.125"$	$h_{nom2} = 1.625"$
		$t_{fix1 \text{ max}}$	$t_{fix3 \text{ max}}$
1/4" x 2 5/8"	3" - t_{fix}	1 1/2"	1"

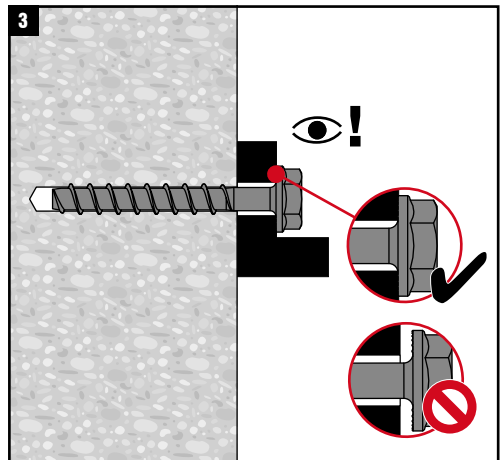

*For non-hole cleaning installation (steps 1.a or 1.b), make sure to drill deep enough to achieve h_i , taking into account the depth of debris remaining in the hole

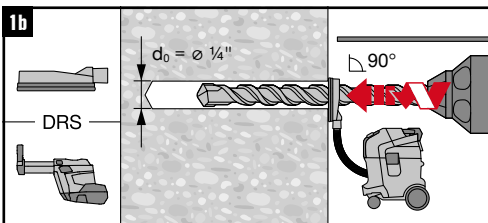
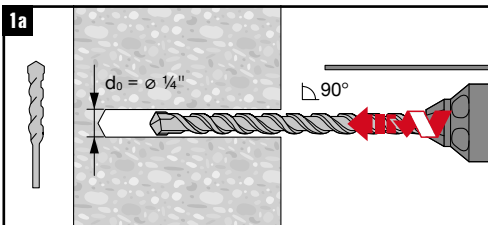
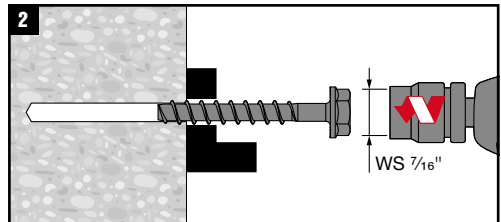
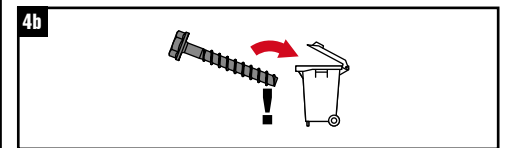
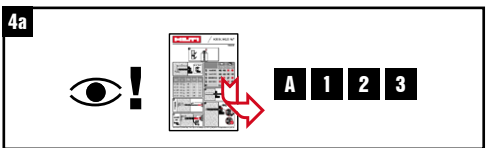
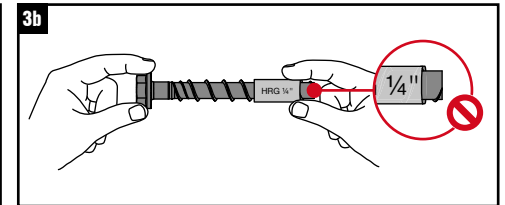
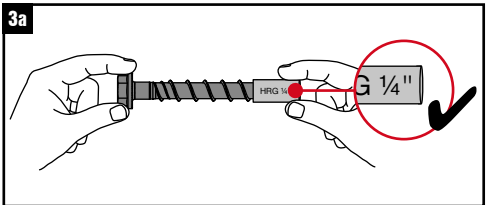
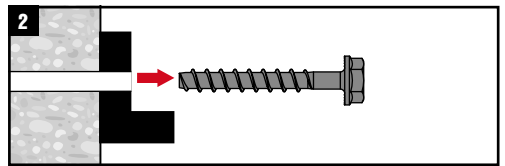
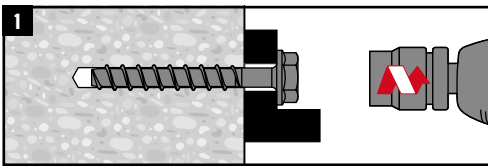
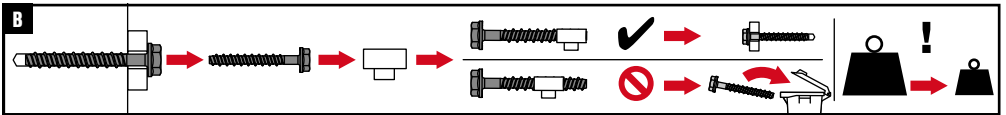
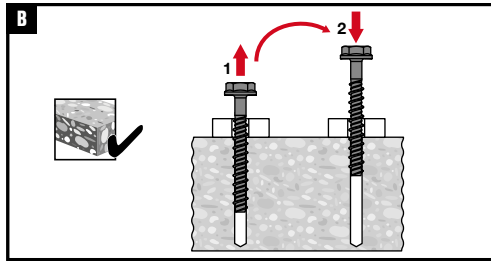

		< 3000 psi	≥ 3000 psi
	Nuron SID 4-22		
	Nuron SID 6-22		
	Nuron SIW 4-22		
	CPC SID 4 22/18-A		
	CPC SIW 6AT-A22		
		10 ft-lb	10 ft-lb